



1 Bingfield Court

, Billingham, TS23 3UX

£180,000



Igomove are honoured to present this impressive and immaculately presented three bedroom detached home, nestled in the great area of Bingfield Court in Billingham. The location benefits from an array of amenities at its doorstep as well as transport link such as the A19 connecting you to major routes and towns. The accommodation of this fantastic home is thoughtfully designed and upgraded, offering a bright and spacious, flowing layout for everyones comfort and convenience which briefly comprises of three bedrooms, one bathroom, large full length open plan lounge/dining area, kitchen, utility room and garage.

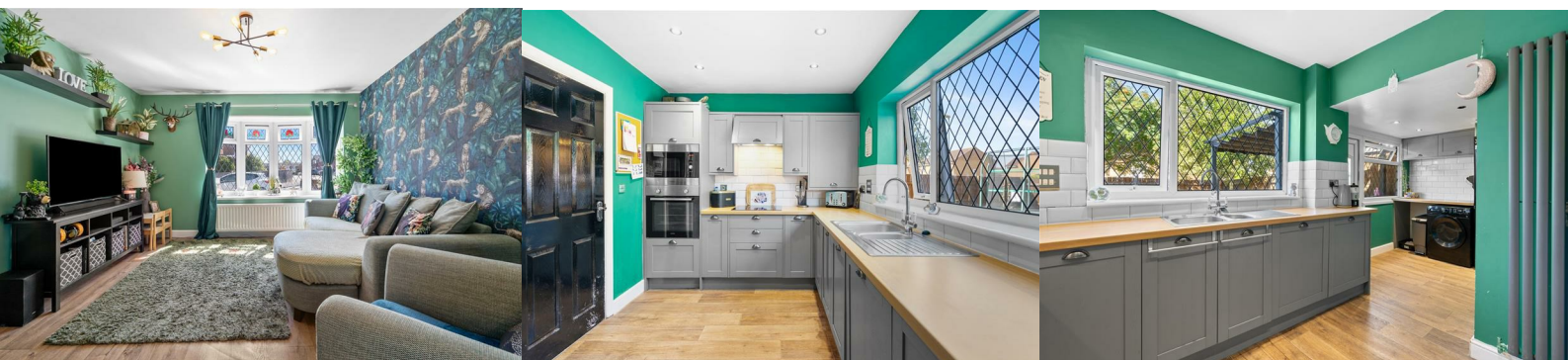

On approach, you are greeted with an attractive and well kept frontage providing ample off street parking, front lawn and garage. Upon entering the property, you are welcomed into the stunning home finished with stylish interior. The hallway is lovely and wide, flooded with natural light which leads you straight into the large open plan lounge /dining area. This gorgeous space is tastefully styled as well as benefitting from immense natural light. Its clever design allows for all of family life activities to take place here but gives a cosiness and privacy to each section. Situated to the rear of the property is the impressive modern fit kitchen which comes integrated with a rang of appliances such as an integrated oven, integrated microwave, dishwasher, hob and extractor fan. Just off the kitchen lies a convenient utility room which also grants access into the rear garden.

The first floor accommodation is home to three bedrooms, the master of which located to front aspect is highly spacious complimented with ample space for free standing wardrobes. The second bedroom also benefits from ample space and bedroom three makes a spacious single bedroom located to front aspect, complimented with a cupboard for extra storage. Completing the upstairs accommodation is the family bathroom. Boasting a three piece white bathroom suite, it comprises of a fitted bath, overhead shower, wash basin and WC. The landing also plays host to a cupboard suitable for further storage.

Externally to the rear, this magnificent home features a low maintenance garden which is not directly overlooked. A decked seating area ideal for hosting and gathering completes this gorgeous space complimented with an overhead pergola. Make this home your own and book your viewing today. Igomove are open 7 days a week.

Area Map

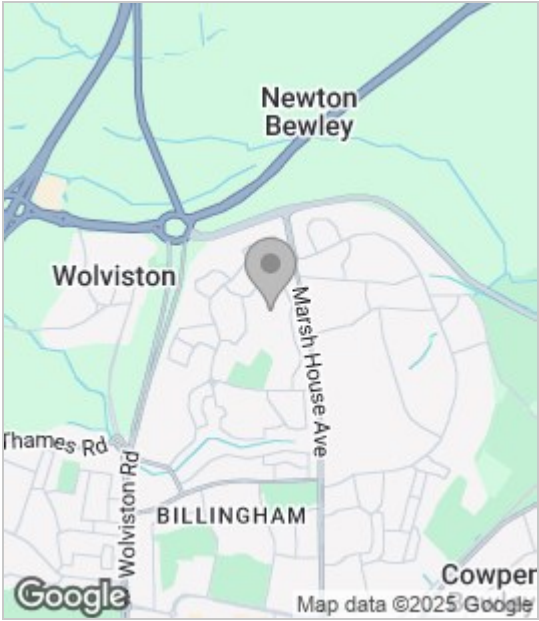

Floor Plan

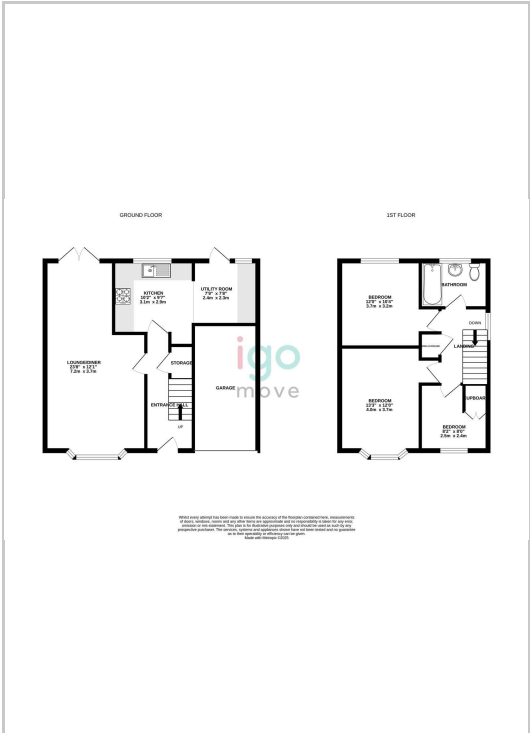

Energy Efficiency Graph

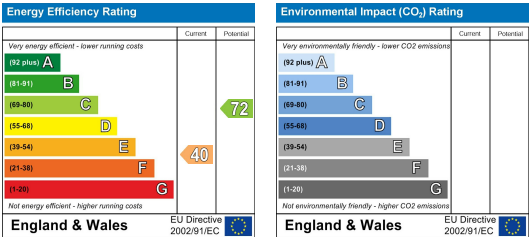

These particulars, whilst believed to be accurate are set out as a general outline only for guidance and do not constitute any part of an offer or contract. Intending purchasers should not rely on them as statements of representation of fact, but must satisfy themselves by inspection or otherwise as to their accuracy. No person in this firms employment has the authority to make or give any representation or warranty in respect of the property.